

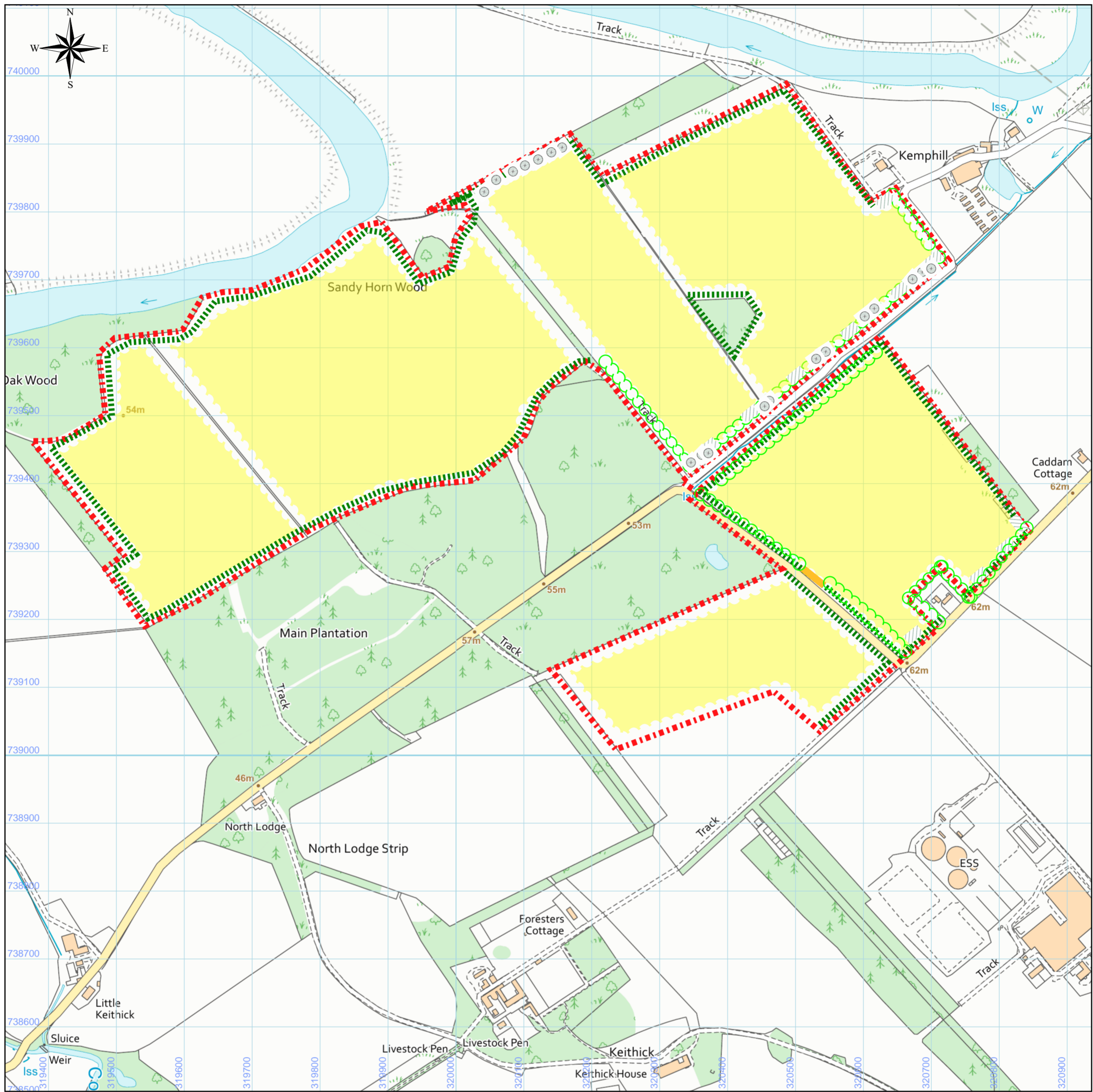

LANDSCAPING & PLANTING



This Plan includes the following Licensed Data: PDF Printed Plan OS VectorMap Local Raster by the Ordnance Survey National Geographic Database and incorporating surveyed revision available at the date of production. Reproduction in whole or in part is prohibited without the prior permission of Ordnance Survey. The representation of a road, track or path is no evidence of a right of way. The representation of features, as lines is no evidence of a property boundary. © Crown copyright and database rights, 2022. Ordnance Survey 0100031673

0m 100m 200m 300m 400m 500m 600m 700m 800m

Scale: 1:5000, paper size: A2

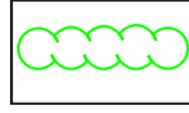
-  Proposed Native Species Grassland and Wildflower Mix
EM10 Tossock Mixture, Emorsgate, 4g/m
-  Proposed Native Species Hedgerow Mix
Native Species Hedgerow, 5/l/m
-  Proposed Access
-  Proposed Native Species Shrub Mix
Native Species Shrub Mix, 0.3/m
-  Proposed Native Species Trees

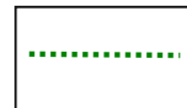
-  Site Boundary
-  Existing Vegetation to be Retained

Planting Schedule

Specimen tree Planting

4 x Ptr Populus tremula 150-175cm 2x :BR :Feather
 4 x Psy Pinus sylvestris 150-175cm 4x :RB
 4 x Bp Betula pendula 150-175cm 2x :BR :Feather
 4 x Agl Alnus glutinosa 150-175cm 2x :BR :Feather
 4 x Ac Acer campestre 150-175cm 2x :BR :Feather
 Total 20

Native Species Hedgerow Mix

24 x Rca Rosa canina 80-100cm 1+1 :BR :Transplant 5/m
 168 x Psp Prunus spinosa 80-100cm 1+1 :BR :Transplant 5/m
 112 x Ia Ilex aquifolium 60-80cm 2L C 5/m
 672 x Cm Crataegus monogyna 80-100cm 1+1 :BR :Transplant 5/m
 34 x Cav Corylus avellana 80-100cm 1u1 :BR :Transplant 5/m
 56 x Csa Cornus sanguinea 80-100cm 1u1 :BR :Transplant 5/m
 56 -x Vo Viburnum opulus 80-100cm 1+1 :BR :Transplant 5/m
 Total 1122

Native Species Shrub Mix

38 x Sn Sambucus nigra 60-80cm 1+1 :BR :Transplant 0.3/m²
 92 x Psp Prunus spinosa 60-80cm 1+1 :BR :Transplant 0.3/m²
 202 x Cm Crataegus monogyna 60-80cm 1+1 :BR :Transplant 0.3/m²
 38 x Ac Acer campestre 60-80cm 1+1 :BR :Transplant 0.3/m²
 Total 370